

Insignia

Insignia Basin Mixer with Press Top Waste

Product Code: INS112

Finish: Chrome

Features

- Construction:Brass
- Valve/Cartridge type:35mm Ceramic Cartridge
- Supply:Suitable For Low Pressure Systems
- Working Pressures:0.1 - 5.0 bar
- Inlet connections:½" BSP
- Flexi or Copper:Flexi Tails - M10 - 400mm

Suitable For High & Low Pressure Systems
35mm Ceramic Cartridge
H & C Temperature Indicator
Tilt And Turn Temperature And Flow Control To Single Flow Outlet
Pre-Fitted Flow Straightener
Tap Height 148mm,
Spout Height 67mm,
Spout Reach 112mm
Fixing Kit
(Metal Horseshoe Fixing Plate, Rubber Horseshoe Fixing Washer, Metal Bar and Locking Nut)
Supplied With 2 X 400mm Flexi Tails
Complete With Press Top Waste



*Please refer to website for full warranty details.

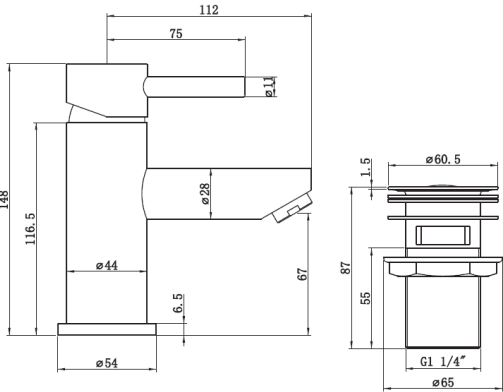

Flow (Bar - l/min, open outlet)

Spout							
Flow 0.1	Flow 0.3	Flow 0.5	Flow 1.0	Flow 2.0	Flow 3.0	Flow 4.0	Flow 5.0
3.3	5	6.6	9.6	13.6	16.7	18.8	20.6

