

Installation should be carried out by a qualified installer and in compliance with Water Regulations, for further details please contact your local water authority.

It is recommended that inlet pressures are as balanced as possible to provide optimum performance from your product.

Always turn off or isolate the water supply, before commencing the work.

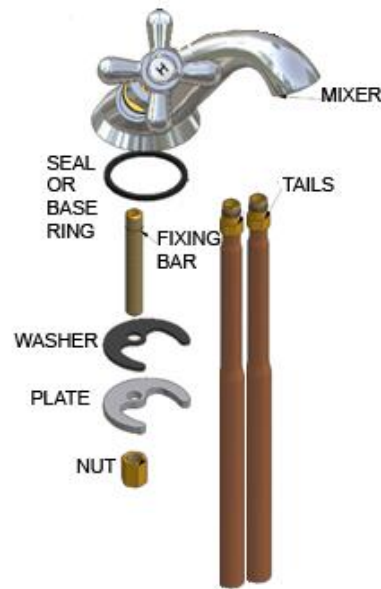

### Installation details

Before commencing installation of the new product, ensure that the system has been flushed to remove any debris, which can damage the seating washer of the valve.

Connect mixer tails to the inlets in the mixer, if a base ring or seal is supplied, you must fit this first, between the base of the mixer and the surface.

The tails can be either copper or flexi-tails, if copper do not bend them more than 30 degrees from the vertical and do not use PTFE on thread inlets of either type.

Screw the fixing bar into the hole in the base of the mixer (dependant on mixer some may use two bars)

Place the fittings through the hole in the basin and position, so that the spout is located over the basin.

From the underside fit the rubber horseshoe washer over the threaded bars, next fit the metal horse shoe plate over the threaded bars and then screw on the fixing nut

Whilst holding the mixer in place tighten the fixing nuts to the underside of the metal plate, then using a spanner secure into place (do not overtighten)

Back Page

### Waste Installation

Fit components to basin as shown in the diagram. Ensuring to apply sealant to underside of waste flange and between basin and washer to assist in sealing. Once fitted tighten back nut.

Once the assembly is complete, connect the waste pipe (not supplied) to the installed basin waste, tighten waste pipe nut onto threaded tail of waste, until watertight.

Then after a period of time, allowing the sealant to set, run the taps to check a seal has been created.

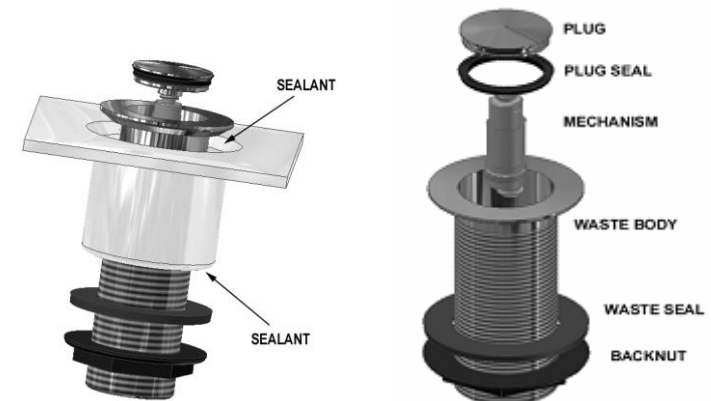

Next place blanking stay (if supplied) thread through hole in basin, if this is required, then connect nut from rear and tighten

To remove the plug, unscrew by hand in an anti-clockwise direction.

To remove the mechanism, unscrew in an anti-clockwise either by hand or using a small spanner

Front Page

### Water Saving

If you require a flow regulator to be fitted to your product and the item you have purchased does not have this fitted, you will need to follow these instructions. The flow regulators come in two forms, either an antispash regulator or a seal regulator.

Outlet regulator installation;

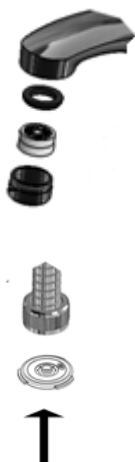

Remove the existing antispash using a spanner, then fit the new version ensuring to fit the rubber seal.

Fully tighten to create seal.

The seal regulator replaces the rubber washer used in the flexi hose end.

Place the regulator into the hose end with the black o ring facing the water flow, so it is visible, before fitting the hose.

Note this regulator cannot be fitted to product with copper tails, but these can be changed to flexi-tails

## Mono Basin Mixer Installation and Maintenance Guide



Please retain this document for future reference.

This product should be fitted in compliance with Water Regulations, by a qualified plumber.

Use only a clean damp cloth to maintain the surface finish, use of abrasive cleaning materials will invalidate your guarantee.

Customer Care Line  
0800 1951602

Website  
[www.deva.org.uk](http://www.deva.org.uk)

English Street  
Lancashire  
WN73EH